



mounting  
systems



## E-Port Home Premium

<b>Application</b>	Open Terrain
<b>Included in the package</b>	<ul style="list-style-type: none"> <li>• Substructure for solar modules</li> <li>• Continuous trapezoidal sheet (approx. 960 x 5170 x 0.70 mm)</li> <li>• Impact anchor 12pcs.</li> <li>• Integrated drainage</li> <li>• LED Lighting</li> <li>• Variable cable routing (cable channel can be fixed in each post in up to 3 places)</li> </ul>
<b>Foundations</b>	Anchored in concrete foundation
<b>Snow load</b>	Max. 0.68 kN/m <sup>2</sup> – on the roof
<b>Wind load</b>	Max. 0.70 kN/m <sup>2</sup> – on the roof
<b>Roof surface</b>	3624 x 5190 mm
<b>Example Modules</b>	Space for up to 6 modules (2278 x 1134 x 35m) <ul style="list-style-type: none"> <li>• with a module power of 575 Wp</li> <li>• Total power 3.45 kWp</li> </ul>
<b>Color</b>	Anthracite gray
<b>Lighting</b>	LED
<b>Requirement</b>	No Shadowing
<b>Warranty</b>	10 years



Open Terrain



Trapezoidal sheet



Framed module



Orientation landscape



Orientation portrait

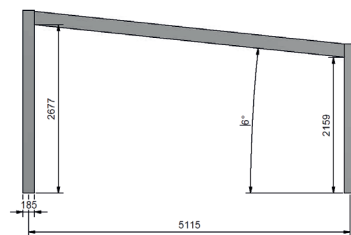

Side view

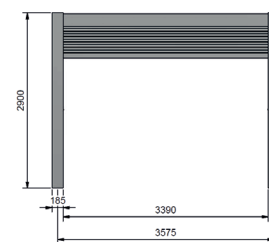

Front view

