



mounting systems



## Trifix ProLine

|                            |  |
|----------------------------|--|
| <b>Application</b>         | Ground mount, flat and pitched roofs                         |
| <b>Height of Building</b>  | Depends on wind loads on site                                |
| <b>PV modules</b>          | Framed, frameless and bifacial                               |
| <b>Module layout</b>       | Rows up to approx. 12 m per frame unit                       |
| <b>Module orientation</b>  | Landscape, portrait  |
| <b>Pitch</b>               | 10°, 15°, 20°, 25°, 30°, 35°, 40°, 45°                       |
| <b>Supporting profiles</b> | Extruded aluminium (ENAW 6063 T66)                           |
| <b>Small parts</b>         | Stainless steel (V2A),<br>Extruded aluminium (ENAW 6063 T66) |
| <b>Colour</b>              | Aluminium: plate finish                                      |
| <b>Warranty</b>            | 10 years   |

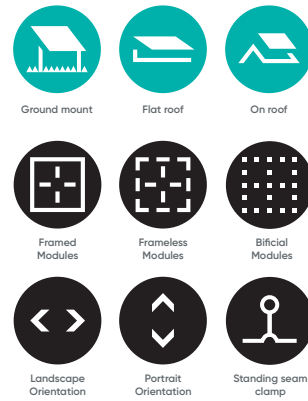

Adapter für Stockschrauben

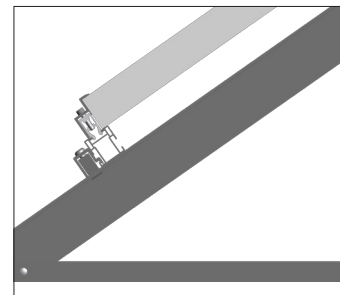

Seitenansicht Aufbau